

BAY AREA WOODWORKERS ASSOCIATION

May 1986 - Vol. 5, Issue 5

Box 421195 San Francisco CA 94142

AT THE APRIL 8TH EMERGENCY BAWA MEETING, THE FOLLOWING MEMORIAL WAS READ BY JOHN GREW-SHERIDAN

For a moment I would like your permission to paraphrase a few lines from Richard Dana's Two Years Before The Mast:

Friday, April 4th, was a black day on our calendar. We all knew quickly when we saw the smoke or felt the blast that it was a disaster and that there was no hope of saving those trapped inside the building. But none of us wished to speak of giving up hope and so we tried for hours to account for friends. We felt the fear and anguish and sorrow . . . and so much happiness when one or another missing person was found.

Death is at all times solemn but never so much as in a small community. Our colleagues and loved ones have been harshly torn from us. There is a suddenness in the event and a difficulty in understanding it. There is an air of awful mystery.

With a fire such as this the person is near you - at your side - you hear the voice and in an instant it is gone and nothing but a void shows the loss.

In a small community such as ours you miss a person so much. It is like losing a limb. It is hard to find faces and scenes to fill the gap. There are empty spaces in your world and in your heart. You miss his or her form and the sound of the voice, for habit has made them almost necessary to you and each of your senses feels the loss. The impact remains with us. We feel more quiet and serious.

We are here tonight with our grief to honor Frank Wallis, Bob Shoemaker, Patty Livingston, Francisco Perla and the others who died in the fire or struggle now to live. We are also here to recognize the pressing needs of our threatened community of artists and artisans. With limited resources we must try to demonstrate tremendous strength. We will do all we can to get everyone back to work.

* * * * *

CALENDAR

AMERICAN STYLE opens at Macy's Union Square in San Francisco on May 9th and continues through June. 90 artists and artisans brought together by the Baulines Guild will represent the "contemporary" part of the exhibition. In addition, there will be an historical survey of work from the turn of the century Arts and Crafts Period.

The New Designs Concepts show continues at the California Crafts Museum. Their display is just above By Design, in the SW corner of Ghirardelli Square.

A special Spring Show is also opening at V. Breier Gallery, 3091 Sacramento St., San Francisco.

THE RELIEF FUNDS

In the past 4 weeks, a lot of time and effort has been spent trying to establish and promote relief funds for victims of the Bayview disaster. Two funds have been established and are being administered by non-profit organizations. Donations to the funds through these organizations are tax-deductable. The funds are:

1. Crafts Emergency Relief Fund/Bayview Fund
c/o American Craft Enterprises
P.O. Box 10
New Paltz, NY 12561

This fund is specifically for artists and craftspeople.

2. Intersection/Bayview Fund
c/o Intersection
766 Valencia St.
San Francisco, CA 94110

All victims of the fire who feel in need of assistance are invited to apply to this fund.

Anybody and everybody wanting to be considered for assistance from these funds must:

1. Apply for assistance.
2. Application should include: Name, address, telephone number and a brief description of losses, needs and amount of insurance coverage.
3. Deadline for applications is May 30, 1986.
4. Mail applications to: Intersection/Bayview Fund
c/o Bay Area Woodworkers Association
P.O. Box 421195
San Francisco, CA 94142
5. If you have further questions, call Bayview info, 822-8688, or Gail Smith, 763-8502.

Applications will be reviewed by a panel of 3 people:

1. Mike Laine, BAWA rep.
2. Leigh Hyams, artists rep.
3. A representative of Intersection.

The group will meet early in June and again in July to review applications and determine fund disbursements.

We have proposed the following guidelines for disbursement of funds, in order of priority, as follows:

1. Lost living space and business; no insurance.
or
Suffered physical injury; no insurance.
2. Lost workspace/business; no insurance.
3. Lost workspace/business; under-insured.

Initially following the fire, we publicized these funds as much as possible during interviews with newspaper, TV and radio reporters. Last week we mailed press releases publicizing the funds to a wide range of media: Newspapers, TV, radio, regional and national arts and crafts publications. So far, we know the information will be printed in the next issues of Artweek, American Craft Magazine, Craft report and Fine Woodworking. Hopefully, many more will publish the press releases. Because of the delays in releasing this information - many publications are bi-monthly or quarterly, it may take awhile for contributions to add up. Currently, the status of the funds are:

1. Crafts Emergency Relief Fund/Bayview Fund.
- Donations have just begun to come in. The San Francisco chapter of the A.I.A. gave \$500. to the fund. Our thanks to Toby Levy for proposing the donation at the recent A.I.A. monthly meeting.
2. Intersection/Bayview Fund.
- Total to date is \$4900. This includes a donation of \$350. from Intersection.

We hope that with the extensive press release mailing that a second wave of contributions will pour into the funds.

Gail Smith

THIRD THURSDAY PREVIEW

Our regular meeting this month will be held at 7:30pm on May 15th and will feature the work of Dean Santner. Dean has a background in art and began his career in woodworking about 15 years ago. His pieces reveal the fine-tuned sense of design and aesthetics of an artist. Dean will show slides of his work and lead a discussion. His strengths include solving the practical problems of production and the uses of abrasives and finishes, so come prepared with questions. We will also hear the latest information on the progress of the Bayview relief efforts.

The meeting will be held at Bob Newhall's shop, 801 54th Ave., Oakland (532-0999). Use 17 south to High St. exit. This exit branches; take the right hand side to Alameda. At the light, turn left under freeway onto High St. Continue 2 long blocks, then turn right onto San Leandro St. Proceed for approximately 10 blocks to 54th Ave. Turn right on 54th. The shop is at the corner on the right side.

The executive meeting will be held at 6pm, preceeding the general meeting, at Chichen Restaurant, 4749 E. 14th St., Oakland. All members are welcome.

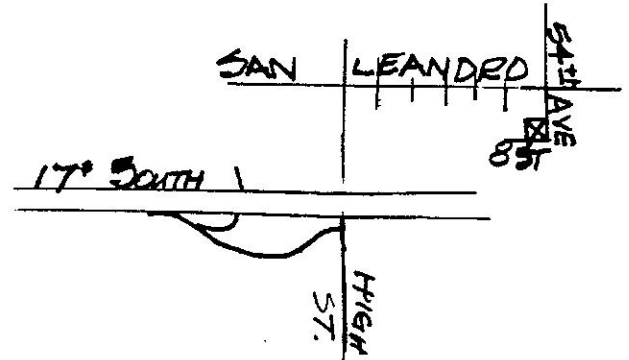

ASSISTANCE FOR SAN FRANCISCO FIRE VICTIMS CONTINUES

As of May 1st, 86 businesses and individuals who were affected by the Bayview Industrial Park fire have been identified by the San Francisco Mayor's Office of Housing and Economic development. More names may be added to the city list as the landlord of BIP has just provided its list of tenants.

To date, 60 applications for Federal disaster relief have been submitted to Sue Lee, the Small Business Development Officer who is administering the City's response to the disaster. She is working in collaboration with the City and State Offices of Emergency Services, the Disaster Office of the Federal Small Business Administration and Assemblyman Art Agnos' staff. The applications for loan assistance are permitted initially to be vague, but the 60 requests total \$5,000,000. in damage claims with a typical individual loss of \$30,000. to \$50,000., and a few businesses claiming over \$100,000. in losses. It appears that insurance coverage was low. So far, only \$350,000. in insurance coverage has been stated. The SBA can offer to qualified applicants, depending on their credit worthiness, either 4% loans for 30 years or 8% loans for 3 years.

Sue Lee also pointed out that the fire victims have many advocates who have written to the Mayor and others to encourage prompt governmental response. Examples that she gave were letters from the American Institute of Architects and the Showplace Square Association, which will be considering how to help at an upcoming meeting. Sue Lee will also be meeting with the City Attorney to get his opinion on whether she can release to BAWA or Intersection For The Arts, the city list of BIP fire damaged businesses and individuals. If she can, VOLUNTEERS will be needed to canvass by telephone those people burned out by the fire to find out how they are doing, and if any emergency funds are needed. Anyone willing to offer an hour or two of telephoning time to help compile an up-to-date survey should call the special BIP number, 822-8688, and leave their name and phone number.

Larry Borsian has been given temporary shop space at Sotirkos Designs and has been able, with long hours and 7-day work weeks, to build again the cabinets that he lost in the fire. Larry, as everyone will recall, was the cabinetmaker who was repeatedly and falsely blamed for the fire. In fact, Larry had in his Bayview shop a "street-legal" spray booth with sprinkler and it had been recently inspected and approved by the fire department.

Available for loan to fire victims or sale to anyone if the BIP woodworkers can't use it, one 10" radial arm saw in excellent condition. New bearings in motor and carriage, new table, new cord. \$325. with blades, one carbide, one steel. Call 824-6161.

Individuals or businesses with shop space or tools or equipment available for loan, sale or as a gift to the woodworkers burned out in the BIP fire should get in touch with the newsletter or call the special phone number, 822-8688, and an effort will be made to publicize the offer. As you can imagine, coordinating this relief effort has been very difficult. It is a full time job and no one can give full time to it.

John Grew-Sheridan

QUESTIONS AND ANSWERS

Q: What are some acceptable woods for turning small lidded boxes on the lathe?

A: Dense woods work best. Cherry, ebony and bulinga are nice to work with.

Kevin Kerwin

Q: How can I gauge the depth when I cut out the center of cylinders on the lathe?

A: Wrap a piece of tape on the blade of your cutting tool at the point where the open end of the piece will be when at full depth. This is determined by holding the tool alongside the work to the desired depth, then marking with the tape.

Kevin Kerwin

Q: How can I make dark decorative lines in my turned spindles?

A: Use a piece of wire to burn lines into the wood. The friction of the wire against the wood will be sufficient to leave a small burned groove. Be careful of the heat buildup in the wire. Use a wooden dowel on each end of the wire as heat absorbing handles.

Palmer Sharpless

Q: How can I avoid having my lathe tools hang up on the toolrest?

A: Make sure the tool rest is smooth first. File and sand away any ridges. Also file away the sharp corners on your lathe tools. Coat the toolrest to lubricate the surfaces.

Palmer Sharpless

Q: What can I use on green wood turnings to control checking?

A: "Water Lock" is a tung oil based sealer which works well for this purpose. PEG is also widely used to control checking in wet wood.

Palmer Sharpless

Q: How can I keep my lathe tools handy while turning but safely out of the way?

A: Build a small tool caddy to hold your tools and mount it on the lathe bed behind the tailstock. The caddy should have "V" blocks or some other form of separators to keep the tools apart. You need cleats on the bottom of the caddy to keep it from vibrating off the lathe bed.

Palmer Sharpless

Q: How can I use sanding discs on contours without getting a rigid flattening effect?

A: Use a layer of very soft foam between the back of the sandpaper and the disc arbor. The foam should be between a quarter and a half inch thick. This also works well for sanding rotating work in the lathe.

David Ellsworth

Q: What effect does mold have on the strength of wood?

A: Molds and stains themselves usually do not weaken wood significantly. However, there are many wood destroying fungi that can lead to total destruction of wood. The presence of molds or stains are an indication of ideal conditions for the growth of fungus.

The reduction of strength in decayed wood cannot be determined without destructive testing which renders the wood useless. Do not use decayed wood where strength is important. One exception to this rule is the case where all decay is restricted to a knot and does not extend into the surrounding wood. Another fact worth noting is that infected wood absorbs water greater than surrounding, non-infected cells. This has implications for staining and finishing splitches.

NOT WILL IT CRACK, BUT WHEN

Many antique tables have cracked tops. Yet the leaves on these same tables are not cracked. The wood is likely from the same tree so why did the top crack and not the leaves?

Many old chests of drawers have split sides. Why did the sides develop cracks?

Repairing the symptom, a crack in the wood is easy - disassemble the piece and then glue the split back together. Sometimes if the split is too rough it needs to be removed and a new piece of wood is let in. It is easy to deal with the symptom - the crack or split.

I'm not interested in dealing with symptoms, I want to cure the problem. I have a unique opportunity, a chance to improve construction and I'm going to take advantage of it. I can look back at 200 years of furniture, see the results of various construction techniques and if possible cure the construction problem.

The reason the table top and the chest side cracked is the wood was not allowed to move. The table top is attached to the frame either by glue blocks, screws or a combination. As the moisture content of the wood varies, the wood changes dimension. The table top wants to change shape but it can't because it is anchored by screws and glue blocks to the base that, because of grain orientation, will change shape less. A board will vary in width much more than in thickness and length. So the table top expands and contracts a greater amount than the base. The tension builds up and finally the top splits. It's not a case of if it will crack, but when.

The chest of drawers crack is due to the same cause as the table top. That cause is using a drawer runner with its long grain perpendicular to the chest sides' long grain sides. As the side expands and contracts the drawer runner inhibits that movement. Finally, either the runner falls off or the side splits.

Look at furniture to learn both the good and less good construction techniques. Then improve upon the techniques that cause problems.

The problem is anchoring long grain to cross grain.

To correct the cracking problem, I attach table tops and drawer runners with screws that are in slots so that movement is allowed. On a table I will attach 1" x 1" strips to the base with the slots drilled perpendicular to the tops grain direction. To cut the slots, I just drill three holes real close and knock the waste out with a chisel. I then use screws with washers to anchor the 2 parts together. The washer keeps the screws from going through the attached wooden strip. The slots allow the top to expand and contract without cracking. The screws and washers can be counter sunk if wanted - I do.

The same principle applies to runners of a chest of drawers. Use the 1" x 1" strips as drawer runners. The slots again are oriented at right angles (perpendicular) to the grain of the sides. This allows for the side to move without cracking.

The method of attaching tops and drawers runners with counter-sunk slots and screws works. It cures the problem and is easy. Don't let your top or chest sides crack again.

D. Douglas Mooberry
Features Editor

The material on this page and the 2 items on safety and finishing on the following page are reprinted from the newsletter of The Society of Philadelphia Woodworkers. Our thanks to SPW.

Newsletter readers might be interested in how one New England woodworker promotes his work. This latest Thomas Moser design is being sold through ads in The New Yorker. A long article on the Moser shops will be in Fine Woodworking later this year.

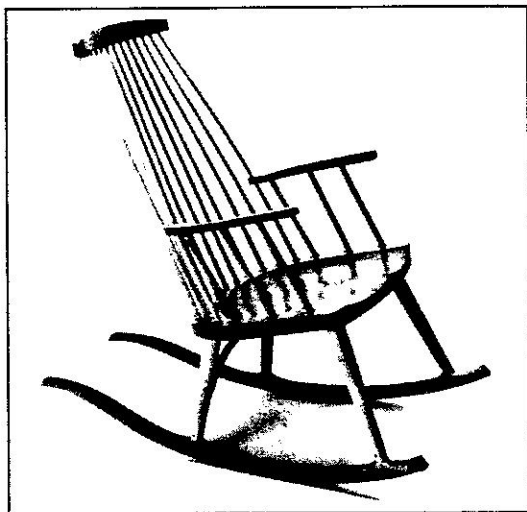

Thos. Moser's New Gloucester Rocker—winner of the 1985 Daphne Award for design excellence. Truly an investment in comfort and grace for \$600.00.

Our new four-color catalog, with many other exciting and affordable designs, is just off the press. Send \$4.00 to:

THOS. MOSER

CABINETMAKERS

415R Cumberland Avenue, Portland, Maine 04101
(207) 774-3791

GREW-SHERIDAN STUDIO

Woodworking classes and supervised independent study since 1975.

Fully equipped shop.
All skill levels are welcome.

500 Treat Avenue
San Francisco 94110

824-6161

SAFETY

Do you know the normal sounds of your power machinery? You should pay close attention to any change in sound. A change in sound could indicate that something is wrong. Bearings may be wearing out and creating excess shaft movement or something may have broken off and thrown the rotating parts out of balance. A cutterhead which is out of balance puts excessive strain on the bearings and even the entire piece of equipment. An out of balance condition can set up vibration in the machine that precludes doing precise work because of the movement it creates in the cutter relative to the supporting surfaces.

If you are using a molding cutter or any sort of multiple cutter rotating equipment, make sure the head is balanced with equal weight on each cutter. If you ever operate a multiple head cutter with less than the full number of cutter blades you should insert some sort of counterweight in the sockets without cutters. Make sure that any such balancing weights are securely fastened and will not be able to work loose while the head is rotating. Loose blades, thrown from a machine, can be fatal. Their force is often sufficient for the thrown piece to penetrate cement blocks.

An obvious indication of trouble is excessive vibration of the machine. In severe cases this may even result in the entire machine bouncing off the floor or moving across the floor like an out-of-balance washing machine in spin cycle. When such vibration is present, stop the machine right now and correct the problem. Continuing to use an incorrectly tuned machine is a hazard to you and often results in additional damage to the machine. Correcting the problem when it first occurs is smart; damage is minimized and safety is maximized.

Ed Graves

MORE ON FINISHING FROM GLENN TYSON

SPW member Glenn Tyson was motivated to contribute the following after the program on finishing July 13.

Sanding. In connection with the topic of the July 13 meeting, I would like to comment about preparation and sanding of veneer plywood and partial board. The idea is to get out the scratches, smooth out the rough grain, clean-up and puddy-up nail holes and cracks. My comments will dwell on getting out the scratches.

Of these there are basically three types: first is the dent where the wood cells are merely compressed. These usually come out easily with a vibrating sander equipped with 150 grit paper. The second type is where the wood cells are actually ripped. With this type it is usually best to put some water on the scratch, then cover the whole panel to avoid a watermark. After it is dry, go over the area, with the grain, using a small piece of coarse paper (about 80 grit) until the scratch comes out without going through the veneer - this is not always so easy. The third type of scratch might be called secondary because it usually comes from coarse paper or the belt sander. Depending on the wood it is not always easy to get out. When in wood like cherry or birch, the scratches are sometimes just left in since they are not easily seen except on close inspection. If the wood is to be stained, then one should try a little harder to remove these scratches. After preparation is complete the surface is ready for a good sealer.

Sand down with fine paper then finish. If one is staining, wipe with water. This will make it easier to see any scratches you've missed that would certainly be seen after staining. Trying to get out scratches after staining can lead to many difficult situations. All to be avoided if possible. After any touch-ups that need to be done are completed the piece should be ready to go.

Glenn Tyson

B.A.W.A. EXECUTIVE ROSTER, SPRING 1986

Chairman	Bob Newhall 2326 Grant St. Berkeley, CA 94703	532-0999, 848-5025
Co-Chairman	Don Dupont 38 Beta Ct., B-6 San Ramon, CA 94583	831-9754, 283-0765
Secretary	Norma Brooks 4973 Elrod Dr. Castro Valley, CA 94546	537-4096
Treasurer	Larry Borsian 1712 Sanchez St. San Francisco, CA 94131	824-2054
Newsletter Editor	Peter Good 1966 Tiffin Rd. Oakland, CA 94602	530-3198

**PLASTIC LAMINATE
SALES & FABRICATION**

Formica • Wilson Art
Laminart • Nevamar
Dura-Beauty • Pionite
• Metallics •

CORIAN
AVONITE



Parkmead Products
930 45th Ave.
Oakland, CA 94601
532-5931

CLASSIFIEDS

READY-TO-USE SHOP, approximately 4000 sq. ft. Central east bay location. 5-year lease available. Co-op may be formed. For details, call Bruce at 548-2393.

WILLIAMS & FOLTZ FURNITURE of Berkeley is looking for beginning woodworkers. For an application, call Judd Williams at (415) 644-2022.

YATES-AMERICAN table saw, model G89. 16-18", 5hp, 3ph, direct drive, with Biesemeyer fence, \$2150.

YATES-AMERICAN table saw, model G81. 12", 2hp, \$1500.

OLIVER model 252 pattern makers lathe. 440v, 3ph, 2hp, 4 speed winding, 16" swing with 5' center-to-center, has faceplates and compound, \$3200.

ROCKWELL jointer, 3", \$250. Call Paco or David, 465-4655.

AIR DRIED - KILN DRIED

KOA

DIRECT FROM THE MILL

ALL DIMENSIONS AVAILABLE

LOWEST PRICES - WE SHIP

PACIFIC LUMBER IMPORTERS

(415) 530-3198

QUALITY SAW WORKS

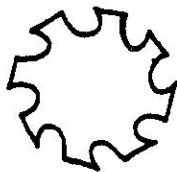

Sales & Sharpening

CARBIDE

Saws • Tools • Cutters
Wood • Metal • Plastic

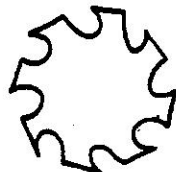

Planer knives & Handsaws

we service the trades

250 BAYSHORE BLVD
SAN FRANCISCO
(415) 282-3060

MACMURRAY PACIFIC

(415) 552-5500

568 Seventh St. San Francisco, CA 94103

**CAN'T FIND IT?
TRY MACMURRAY PACIFIC!**

*MacMurray Pacific carries an extensive line of
woodworkers hardware, tools and shop supplies.*

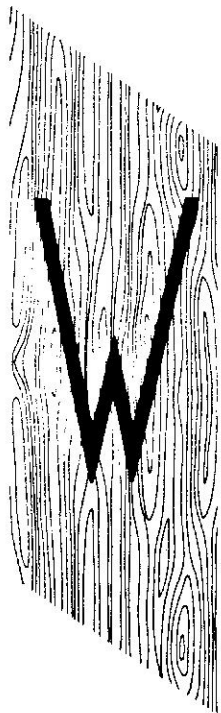

we offer a large selection of fine
woodworking tools for the shop
and professional carpenter at the
lowest prices.



OPEN 7 DAYS

Mon-Sat 10-6 • Sun 11-5

WHOLE EARTH ACCESS

BERKELEY
7th & Ashby 845-3000

SAN FRANCISCO
401 Bayshore Blvd. 285-5244

SAN RAFAEL
863 E. Francisco Blvd. 459-3533

PLYWOOD AND LUMBER SALES INC.

- Hardwood
- Hardwood Plywood
- Lumber
- Hardwood Flooring
- Kortron
- Mouldings
- Marine Plywood
- Large Inventory



SMALL

(415) 547-7257

BUSINESS

5749 LANDREGAN STREET • EMERYVILLE, CA 94609

ROSEWOOD

The Woodworker's Resource

Call for a FREE newsletter!

1836 Fourth St. Berkeley

415 • 540 • 6247



HARDWOOD LUMBER & PLYWOOD

Hardwoods Since 1872

RETAIL-WHOLESALE

Red Oak • White Oak • Birch
Maple • Walnut • Ash • Cherry
Teak • Exotics
Custom & Stock Moldings
Laminated Maple Tops
Hardwood Dowels

Open

M-F/8-5 pm

SAT 8:30-2 pm

415-261-1600

WE DELIVER

4801 Tidewater Ave., Oakland Nimitz Fwy to High St.

SARTOR SAW WORKS

All Saws Sharpened or Repaired • Pick-up/delivery
Sales & Prompt Service

Carbide Saws and Router Bits Our Specialty

289 Bayshore Blvd., San Francisco
Phone: (415) 282-6093

BAY AREA WOODWORKERS' ASSOC
POST OFFICE BOX 421195
SAN FRANCISCO CA 94142

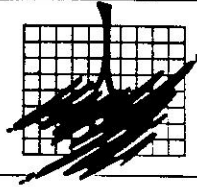

2150 OAKDALE AVENUE
SAN FRANCISCO, CA 94124
(415) 647-0782

930 ASHBY AVENUE
BERKELEY, CA 94710
(415) 843-4390



BAWA DATA

The Bay Area Woodworkers' Association is an organization of woodworkers who have banded together to promote woodworking in both technical and aesthetic directions. This newsletter is a monthly publication intended to serve as a communications vehicle and a source directory for the membership of this Association.

Membership dues are \$20/year, for which any member may participate fully in the Association, in accordance with the guidelines set forth in the By-Laws. This includes voting power on any issue brought before the membership for a vote, notification of the monthly shop talks and demonstrations put on by the Association, receipt of this newsletter each month, and privilege of participation in any special discount programs sponsored by local businesses in conjunction with this Association.

Checks for membership dues may be made out to the Bay Area Woodworkers' Association and sent to P.O. Box 421195, San Francisco, CA 94142. Membership cards will be issued to all members in good standing.

Copies of the By-Laws are available at all monthly meetings, or can be requested by mail.

The monthly shop talks and demonstrations are held on the third Thursday of each month at 7:30 p.m., at a location announced both in the newsletter and at the previous meeting.

The monthly executive committee meetings are held on the fourth Thursday of every month, and are open to any interested members. To arrange attendance, contact any member of the executive committee by telephone or the address given above.